

# Características Técnicas

## PVC DIN gravel pre-coated screens



### Descripción del producto:

PVC-U pipe standardized in accordance with DIN 4925 with gravel pre-coated screens. Offers the advantage of a uniform gravel distribution down to depths where separate gravel packing is either too expensive and/or cannot be conducted effectively



### Propiedades:

- Material: PVC-U
- Construction lengths: 1 – 4 m
- Connection tupe: Pipe of trapezoidal thread
- well-rounded quartz gravel (96% SiO<sub>2</sub>)

### R = Pipe thread:

Cylindrical inner thread in accordance with DIN 4925 part 1, with reference to DIN 10226-1, and conic outer thread, pitch 11 turns per inch, DN 35-DN 100

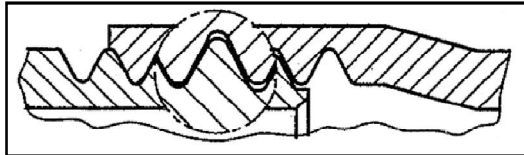

### T = Trapezoidal thread:

As per DIN 4925 Part 2 and 3, 6 mm pitch: DN 100-DN 200, 12 mm pitch: DN 250-DN 400, DN 500 and DN 600 as per factory standard; special seal ring available on request

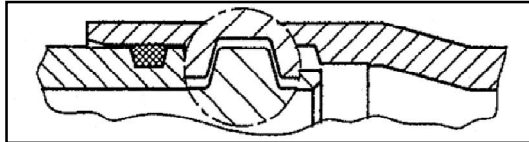

### Propiedades físicas del material:

Propiedades			Método de ensayo
Modulo de elasticidad	N/mm <sup>2</sup>	2500 a 3000	DIN EN ISO 178
Resistencia al impacto a 20°C para el PVC-U normal	kJ/m <sup>2</sup>	3 a 5	DIN EN ISO 179
Densidad	g/cm <sup>3</sup>	1.4	DIN 53479
Resistencia a la tracción	N/mm <sup>2</sup>	45 a 55	DIN EN ISO 527-2
Resistencia al impacto		Max. 10% ruptura	Basado en DIN EN ISO 179
Temperatura de deformación Vicat	°C	80	DIN EN ISO 306

GWE TUBOMIN S.A.  
Los Arrayanes 450 – Colina.  
Santiago – Chile.  
Teléfono +56 2 27387294  
Fax +56 2 27387310



# Características Técnicas

## PVC DIN gravel pre-coated screens



### LINEA KK – Screens standard wall

Nom. diameter (DN)	Exterior diameter over box (mm) $d_5$	Wall thickness S (mm)	Min, inner diameter min (mm)	Weight (Kg/m)	Max. external diameter over gravel $d_3$ (mm)	Thicknedd of gravel layer $s_1$ (mm)	Type of thread
35	46	3,5	33	3,4	66	11	R
40	53	3,5	39	3,5	72	11	R
50	66	4,0	50	5,0	91	15	R
80	94	4,0	77	8,0	122	16	R – T
100	121	5,0	98	11,5	146	16	R – T
115	132	5,0	110	12,5	160	16	T
125	149	6,5	122	13,5	173	16	T
150	176	7,5	146	17,2	199	16	T
175	205	8,5	170	20,0	227	16	T
200	241	10,0	195	24,5	259	16	T
250	297	12,5	243	33,5	312	15	T
300	350	14,5	290	44,0	364	16	T
350	425	17,5	350	63,0	439	18	T
400	475	19,5	395	74,0	488	18	T

#### Lenghts

DN 35 a DN 80  
DN 100 a DN 400

#### Serie KK

1,0 m  
2,0 m

#### Slot widths and gravel sizes

Slot 0,75 mm / 0,7 – 1,2 mm. | Slot 2,0 mm / 2,0 – 3,0 mm.  
Slot 1,50 mm / 1,5 – 2,0 mm. | Slot 2,0 mm / 3,5 – 5,0 mm.

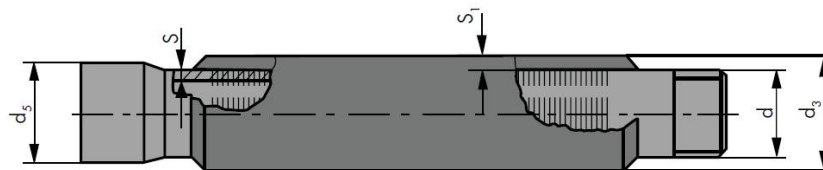

GWE TUBOMIN S.A.  
Los Arrayanes 450 – Colina.  
Santiago – Chile.  
Teléfono +56 2 27387294  
Fax +56 2 27387310



# Características Técnicas

## PVC DIN gravel pre-coated screens



### LINEA KKV – Screens reinforced wall

Nom. diameter (DN)	Exterior diameter over box (mm) $d_5$	Wall thickness S (mm)	Min, inner diameter min (mm)	Weight (Kg/m)	Max. external diameter over gravel $d_3$ (mm)	Thicknedd of gravel layer $s_1$ (mm)	Type of thread
100	125	7,0	94	12,5	146	16	R – T
115	137	7,5	105	13,8	160	16	T
125	152	8,0	118	14,4	173	16	T
150	180	9,5	140	18,6	199	16	T
175	211	11,5	163	22,8	227	16	T
200	247	13,0	188	27,3	259	16	T
250	304	16,0	236	37,5	312	15	T
300	359	19,0	281	50,2	364	16	T
350	433	21,5	342	69,7	439	18	T
400	490	23,5	387	81,5	488	18	T

Screens with DN 100 and bigger can be supplied with even heavier wall thickness and are identified as "KKV".

Lenghts  
DN 100 a DN 400

Serie KKV  
2,0 m

Slot widths and gravel sizes  
Slot 1,50 mm / 1,5 – 2,0 mm. | Slot 2,0 mm / 3,5 – 5,0 mm.

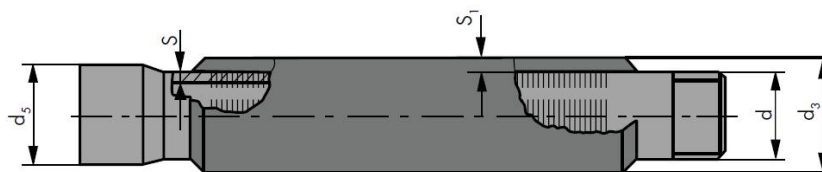

**GWE TUBOMIN S.A.**  
Los Arrayanes 450 – Colina.  
Santiago – Chile.  
Teléfono +56 2 27387294  
Fax +56 2 27387310

